



M3A.250

2 CHANNEL POWER AMPLIFIER

Illustration Guide

For more informations <www.macrom.ch>

 Input setting

 Filter setting

Low Level Input

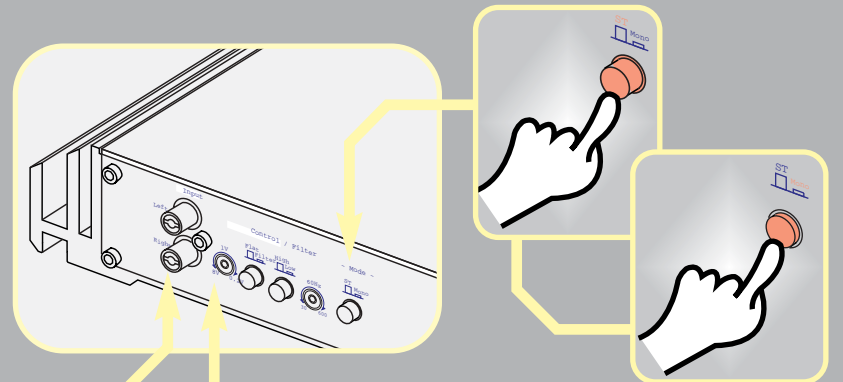
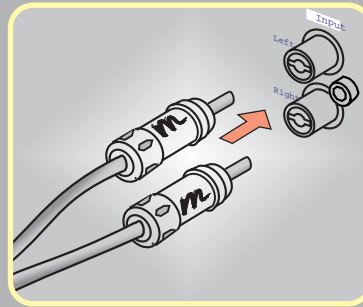

ST / mono selector

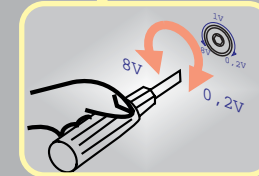

Gain Control Adjust

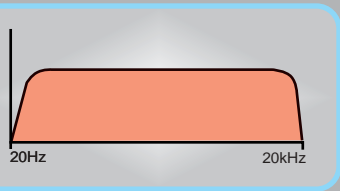

Flat Response

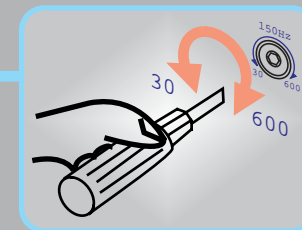
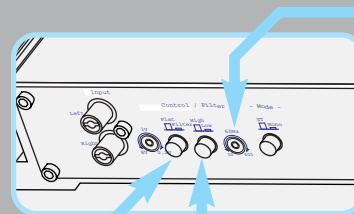

high pass filter control

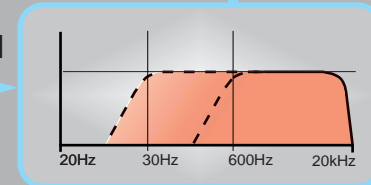

or

Low pass filter control

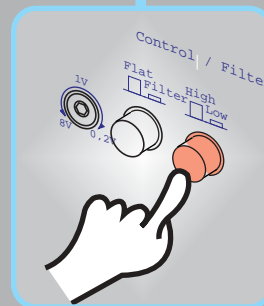
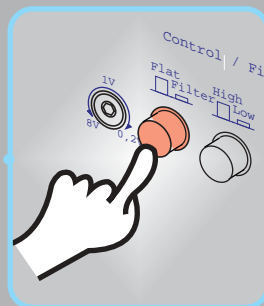
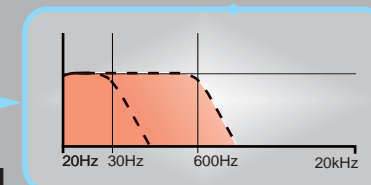

FILTER
Low pass
or
High pass

or

